



March 2-3, 2007

# 5<sup>th</sup>

*Loyola College in Maryland  
Department of Pastoral Counseling  
&  
Division 36 (Psychology of Religion)  
of the American Psychological Association*

“Called or Not ... God Will Be Present”

Carl Jung

---

# The Sanctuary at Dellwood Springs

---

Situated on Rt. 108 in Highland, MD  
Convenient to Baltimore, Annapolis and Washington, D.C.  
Accepting Reservations for Summer and Fall  
1-301-854-1120 - 1-888-607-3223



An OASIS of tranquility on 22 acres of secluded woodland forest, trails, and streams.

Read in the library  
Relax by the pool  
Walk the labyrinth  
Enjoy the wildlife in your favorite spot

The Perfect Place for  
Small Group Retreats  
(Day, Week or Weekend)  
Corporate Meetings and  
Housing  
Private Events  
Wedding Receptions

# Acknowledgements...



**LOYOLA**  
COLLEGE IN MARYLAND

*This conference could not happen without the support of many people and groups. For the fifth year, Loyola College continues to be generous in providing access to its wonderful, state-of-the-art facilities here in Columbia.*

*Division 36 of the American Psychological Association is appreciated for their continued participation and co-sponsorship of this event.*

*The Department of Pastoral Counseling also contributes much support, both in terms of material and personnel.*

*However, it is the people who provide their time and talent to the conference that make it so successful. Special thanks are given to those administrators whose support enables so much:*

*Father Brian Linnane, President of Loyola  
James Buckley, Dean of Faculty of the College of Arts and Sciences  
Amanda Thomas, Associate Dean, College of Arts and Sciences*

*Thanks are also extended to Joseph Ciarrocchi, Chair of the Pastoral Counseling Department, and the entire faculty for their many contributions to all aspects of the conference.*

*But at the heart of putting on a conference are those individuals who really add the core "muscle" to the event, the people who manage the day to day operations of the event. Very special thanks to Brenda Helsing, her magic touches every aspect of the conference, from monitoring registrations to designing the forms and program guide. Special thanks to A.J. Tepe for her work providing food and snacks. Finally to Donna Parker and her student volunteers who staff all the many positions required to run the event. Thank You to all!!*

*Ralph L. Piedmont, Ph.D.  
Conference Director*



---

Thank you to Panera Bread for sponsoring our Conference lunches. In Maryland, there are currently 34 bakery-cafes.

Please visit [www.panerabread.com](http://www.panerabread.com) to find your local neighborhood Panera Bread bakery-cafe.

---

## Events and CEU Information

**Registration** Opens at 8:00 am, Thurs., Fri., and Sat.

**Opening Ceremony** - Friday, March 2, 10:30 - 11:15 am

*Guest Speakers:*

Rev. Brian Linnane, S.J., Ph.D. - President of Loyola College in Maryland  
Joseph Ciarrocchi, Ph.D., Chair, Pastoral Counseling and Spirituality  
Ralph Piedmont, Ph.D., President, Division 36 - APA & Director, Mid-Year Conference and Pre-Conference

**Invited Speakers** (see bios in back of Program Guide)

*Roland R. Griffiths, Ph.D. & William A. Richards, Ph.D.*

**Psilocybin and the Frontier of Experimental Mysticism**

*Kevin S. Masters, Ph.D.*

**Psychophysiological Reactivity to Stress: A Possible Bridge Between Religion and Health**

*Ralph W. Hood, Jr., Ph.D.*

**The Contemporary Christian Serpent Handlers of Appalachia**

*Richard Gorsuch, Ph.D.*

**On the Limits of Scientific Investigation: Miracles**

*Deborah van Deusen-Hunsinger, Ph.D.*

**Keeping an Open Heart in Troubled Times: Self-Empathy as a Christian Spiritual Practice**

*Jean Kristeller, Ph.D.*

**Dimensions of Spiritual and Religious Engagement**

Visions in Conflict I and II

**Gala Reception** Friday, March 2, 5:15 - 7:15 pm (All are invited to attend - cash bar)

**Student Meeting for Psychology of Religion**

Saturday, March 3, 9 - 10 am, Room 260 - **All Students Are Welcome!**

**Division 36 Executive Committee Meeting**

Saturday, March 3 - 11 am - 12:30 pm, Room 280

**Poster Sessions I and II**

Saturday, March 3 - 11 am - 12:30 pm, Poster Session I, Room 210/230

Saturday, March 3 - 12:30 - 2 pm, Poster Session II, Room 210/230

**CEUs**

Continuing Education Credits (CEUs) are available and recognized by the American Psychological Association. To receive CEU credits for sessions you attend, the following guidelines **must** be followed:

1. Register at the CEU table in the main registration area (first floor lobby).
2. Pay a \$60.00 fee charged to cover administrative and material costs.
3. Pick up an attendance form at the registration desk.  
You will need to enter the session number and name of presentation for each session you attend. Return this form at the end of the conference (to the first floor lobby CEU table).
4. Sign in **AND** out of each session. Forms and a volunteer attendant will be available in each presentation room.
5. Complete an evaluation form for each session you attend.
6. Certificates will be mailed to your registered address within 3 weeks.

## **THURSDAY - March 1 (Pre-Conference) Speakers and Presentations**

**Full Day - 9:30 am – 4:30 pm**

### **#1 Judith Miller, Ph.D.**



“Towards Psycho-Spiritual Development:  
A New Therapeutic Group Model”

### **#2 Lee Richmond, Ph.D.**



“Living in the Space Between: Spiritual Approaches to Life-Career Counseling”

---

**1/2 Day - 9:30 am – 12:30 pm**

### **#3 Joseph Ciarrocchi, Ph.D.**



“Positive Psychology and Spirituality: Implications for Research and Clinical Interventions”

### **#5 Mark McMinn, Ph.D.**



“Integrative Psychotherapy: Towards a Comprehensive Christian Approach”

### **#4 Maria Mouratidis, Ph.D.**



“Clinical and Spiritual Care of Trauma”

**1/2 Day - 1:30 pm – 4:30 pm**

### **#6 Bonny Forrest, Ph.D.**



“Integration of Spirituality into Interventions with Children and Adolescents”

### **#7 William Hathaway, Ph.D.**



“Practice Guidelines for Clinical Work with Religious/Spiritual Issue”

## Friday March 2

Time	Room 360/362	Room 261	Room 262	Room 270	Room 271	Room 272
10:30 am - 11:15 am	<b>Opening Ceremony Room 210/230 - Second Floor</b>					
11:30 am	<b>#103</b> <i>Invited</i> Psilocybin and the Frontier of Experimental Mysticism <i>R. Griffiths</i> <i>W. Richards</i> 12:30 pm			<b>#102</b> <i>Sym</i> Religion and Health R.F. Gillium N. Dupree T. Obisesan L. Finer J. Jones H. Trulear D. So 12:50 pm	<b>#101</b> <i>Sym</i> Spiritual Stress Busters A. Portafoglio L. Steele A. Cosenza 12:50 pm	
12:30 pm - 2:00 pm	<b>Conference Lunch - 3rd Floor</b>					
2:00 pm	<b>#104</b> <i>Invited</i> Visions in Conflict I Moderator B. Alston Presenters S. Handwerker S. Hawes C. O'Keefe 3:50 pm			<b>#106</b> <i>Sym</i> Spiritual Stability or Disturbance as Markers of Human Flourishing J. Ciarrocchi G. Yanni-Brelsford J. Cornstock R. Dennison-Tedesco G. Dy-Liacco R. Thukral D. Bughar J. Buckley S. Marinelli D. Rollison 3:50 pm		<b>#105</b> <i>Sym</i> Consulting and Coaching with Religious Organizations and Leaders C. Carney W. Courville C. Scriber L. Raudenbush 3:20 pm
3:00 pm		<b>#108</b> <i>Paper</i> Spiritual Predators S. Hillman 3:50 pm	<b>#107</b> <i>Paper</i> Children and Adolescents Spiritual Growth B. Bounds M. Painton S. Reeder 3:50 pm		<b>#109</b> <i>Paper</i> Spiritual Issues in Psychotherapy and Promoting Positive Change R. York B. McCorkle S. deHoff C. Roos A. Wilson E. Culler 4:20 pm	
3:30 pm						<b>#110</b> <i>Paper</i> Thematic Analyses of Trends and Controversies in the Psychology of Religion K. Gillespie L. Hummel C. Mirman 4:50 pm
4:00 pm -	<b>#112</b> <i>Invited</i> On the Limits of Scientific Investigation: Miracles R. Gorsuch 4:50 pm		<b>#113</b> <i>Paper</i> Personality Correlates of Spirituality F. Volk C. Coultas S. Ignacio A. Lawler D. Ryan J. Hill S. Hales S. Leven 4:50 pm	<b>#111</b> <i>Paper</i> Spiritual Adjustment Across the Life Span C. Rayburn O. Stine D. LaFaber S. Jenks H. Maddy R. Paloutzian E. Swenson C. Park 4:50 pm		
5:15 pm - 7: 15 pm	<b>Gala Reception - Room 210/230 - Second Floor</b>					

# Saturday, March 3

**GRID - Saturday, March 3, 2007**

Time	Room 360/362	Room 260	Room 262	Room 271	Room 272	Room 210/230
10:00 am	<b>#116</b> <i>Invited</i> Keeping an Open Heart in Troubled Times: Self-Empathy as a Christian Spiritual Practice <i>D. van Deusen-Hunsinger, Ph.D.</i> 10:50 am	<b>#114</b> <i>Sym</i> <i>The Psychological and Spiritual Landscape of Clergy Sexual Abuse</i> <i>N. Murray-Swank</i> <i>M. Kohn</i> <i>M. Klausner</i> <i>M. Austin</i> 10:50 am			<b>#115</b> <i>Sym</i> <i>Hope Self-Determination, and Health</i> <i>A. Scioli</i> <i>E. Checko</i> <i>S. McNeil</i> <i>V. Partridge</i> 10:50 am	
11:00 am	<b>#117</b> <i>Invited</i> Psychophysiological Reactivity to Stress <i>K. Masters</i> 11:50 am	<b>#118</b> <i>Paper</i> <i>Cross Cultural Issues in the Psychology of Religion -</i> <i>E. Tisdell</i> <i>A. Tapia-V</i> <i>E. Haraldsson</i> <i>P. Gonzalez</i> <i>C. Delgado</i> 11:50 am		<b>#119</b> <i>Paper</i> <i>Issues in Forgiveness</i> <i>L. Toussaint</i> <i>A. Cheadle</i> <i>M. Leach</i> 11:50 am		<b>#120</b> <i>Poster Session I</i> 12:30 pm
12:00 pm - 1:30 pm	<b>Conference Lunch - 3rd Floor</b>					
12:30 pm						<b>#121</b> <i>Poster Session II</i> 2:00 pm
1:00 pm	<b>#124</b> <i>Invited</i> Dimensions of Spiritual and Religious Engagement <i>J. Kristeller</i> 1:50 am	<b>#123</b> <i>Sym</i> <i>Trauma and Spirituality</i> <i>C. Park</i> <i>M. A. Mills</i> <i>D. Edmondson</i> <i>M Kolto-Rivera</i> 2:20 pm		<b>#122</b> <i>Sym</i> <i>Forgiveness, Gratitude, Appreciation, mental and Biopsychosocial Health</i> <i>P. Friedman</i> <i>L. Toussaint</i> <i>J. Webb</i> <i>A. Cheadle</i> <i>K. Brewer</i> 2:20 pm		
2:00 pm	<b>#125</b> <i>Invited</i> Contemporary Christian Serpent Handlers of Appalachia <i>R. Hood</i> 2:50 pm					
2:30 pm			<b>#127</b> <i>Paper</i> <i>Spiritual Techniques for Growth</i> <i>K. Jordan</i> <i>P. Steffen</i> <i>K.Ladd</i> <i>G. M. Leffel</i> 3:50 pm	<b>#126</b> <i>Paper</i> <i>Spiritual &amp; Mental &amp; Physical Health</i> <i>E. Robinson</i> <i>A. Price</i> <i>P. Murphy</i> <i>G. Fitchett</i> <i>R. Chen</i> <i>E. Horsman</i> <i>P. Summers</i> 3:50 pm		
3:00 pm	<b>#130</b> <i>Sym</i> <i>Visions in Conflict II</i> <i>Moderator</i> <i>B. Alston</i> <i>Presenters</i> <i>R. Gorsuch</i> <i>H. Ullah</i> <i>W. Clough</i> <i>L. Miller</i> 3:50 pm	<b>#128</b> <i>Sym</i> <i>Images of God, Spiritual Attachment, and Subjective Well-Being in Adult Victims of Child Abuse</i> <i>J. Ciarrocchi</i> <i>M. Galea</i> <i>R. Wicks</i> <i>S. Van Deusen</i> <i>N. Scheers</i> <i>C. Courtois</i> <i>E. Deneke</i> <i>S. Cheston</i> <i>L. Richmond</i> <i>R. Piedmont</i> 3:50 pm			<b>#129</b> <i>Paper</i> <i>Working with Orthodox Jewish Clients</i> <i>M. Schulman</i> <i>R. Kaplan</i> <i>E. Harai</i> <i>J. Cecero</i> 4:50 pm	
3:30 pm						

## **FRIDAY - MARCH 2** **Speakers and Presentations**

10:30 am	11:15 am	<b>Opening Ceremony</b> Room 210/230
----------	----------	---

*Guest Speakers:*

Rev. Brian Linnane, S.J., Ph.D. - President of Loyola College in Maryland  
Joseph Ciarrocchi, Ph.D., Chair, Pastoral Counseling and Spirituality  
Ralph Piedmont, Ph.D., President, Division 36 - APA & Director, Mid-Year Conference and Pre-Conference

<b>Session Name:</b>	<b>Spiritual Stress Busters</b>		
<b>Session Number:</b>	<b>101</b>		
11:30 am	12:50 pm	Room 271	<b>Event Symposium</b>

- Title**     ***The Source and Purpose of Pressure***  
                  Anthony Portafoglio (*CUNY*)
- Title**     ***How to Handle Pressure***  
                  Lanor Steele (*The College of New Rochelle*)
- Title**     ***Four Remaining Ways to Handle Pressuring Circumstances***  
                  Anthony Cosenza (*The College of New Rochelle*)

<b>Session Name:</b>	<b>Religion and Health</b>		
<b>Session Number:</b>	<b>102</b>		
11:30 am	12:50 pm	Room 270	<b>Event Symposium</b>

R.F. Gillum (*National Center for Health Statistics*) - Chair  
Harold Dean Trulear (*Howard University*)  
Dominicus So (*Howard University*)

- Title**     ***Introduction to the National Health and Nutrition Examination Survey (NHANES) Web-Tutorial***  
                  Natalie Dupree (*National Center for Health Statistics*)
- Title**     ***Frequency of Attendance at Religious Services and Survival with Chronic Cardiopulmonary Disease or Cancer in a US National Cohort Aged 40 and Over***  
                  Thomas Obisesan (*Howard University*)
- Title**     ***Premarital Sex in the United States, 1954-2003***  
                  Lawrence B. Finer (*Guttmacher Institute*)
- Title**     ***How Does the Religion in Which a Man was Raised and His Current Religiosity Affect His Use of Contraception?***  
                  Jo Jones (*National Center for Health Statistics*)

## FRIDAY - MARCH 2

### Speakers and Presentations

<b>Session Name:</b>	<b>Invited Address</b>		
<b>Session Number:</b>	<b>103</b>		
11:30 am	12:30 pm	Room 360/362	<b>Event</b> <i>Invited Address</i>

**Title**     ***Psilocybin and the Frontier of Experimental Mysticism***  
                   Bill Richards (*Private Practice*)  
                   Roland Griffiths (*Johns Hopkins University*)

12:30 am	2:00 pm	<b>Panera Bread Lunch</b>
3rd Floor Student Lounge, Rooms 330 & 304		

<b>Session Name:</b>	<b>Visions in Conflict I</b>		
<b>Session Number:</b>	<b>104</b>		
2:00 pm	3:50 pm	Room 360/362	<b>Event</b> <i>Symposium</i>

Brian Alston - Moderator

- Title**     ***Building the Inter-Faith Dialogue: Lessons Learned One Faith at a Time***  
                   Steven Handwerker (*Int'l Assoc for the Advancement of Human Welfare*)
- Title**     ***Peacemaking as Ethical Being: Difference, Dialogue, and Hermeneutic Practice***  
                   Susan E. Hawes (*Antioch University*)
- Title**     ***Reconciliation and Peace through Recreation, Play, and Leisure***  
                   Catherine O'Keefe (*University of South Alabama*)
- Title**     ***Visions in Conflict***  
                   Abdullah Hasan (*Long Island Jewish Hospital*)

<b>Session Name:</b>	<b>Consulting and Coaching with Religious Organizations and Leaders: Military and Civilian Programs</b>		
<b>Session Number:</b>	<b>105</b>		
2:00 pm	3:20 pm	Room 272	<b>Event</b> <i>Symposium</i>

- Title**     ***Integrative and Spiritual Dimensions of Professional Coaching***  
                   William J Courville (*Private Practice*)
- Title**     ***Strategic and Spiritual Development of a Military Religious Organization and Its Leaders***  
                   Caren M Carney (*The Carney Group*)
- Title**     ***An Archdiocesan Program to Provide Leadership Coaches for Developing and Transitioning Pastors***  
                   Clarice L Scriber, Linda Raudenbush (*Clarity Consulting Inc*)

## FRIDAY - MARCH 2

### Speakers and Presentations

**Session Name:** Spiritual Stability or Disturbance as Markers of Human Flourishing: Empirical Findings and Theological Dialogue  
**Session Number:** 106  
2:00 pm 3:50 pm Room 270 **Event** Symposium

James Buckley (*Loyola College in Maryland*)

**Title** ***The Buffering Effect of Image of God on the Relationship Between Social Support and Purpose in Life***

Stephanie B Marinelli, Desmond Bugar (*Loyola College in Maryland*)  
Gina M Yanni-Brelsford (*Penn State University*)  
Joseph W Ciarrocchi (*Loyola College in Maryland*)

**Title** ***Ego-Resiliency and Purpose in Life: Links to Spiritual Experiences***

Gina M Yanni-Brelsford, Rajat Thukral (*Penn State University*)  
Joseph W Ciarrocchi (*Loyola College in Maryland*)

**Title** ***Spiritual Struggle, Social Support, Personality, and Flourishing***

Gabriel Dy-Liacco (*Regent University*)  
Joseph W Ciarrocchi (*Loyola College in Maryland*)  
Gina M Yanni-Brelsford (*Penn State University*)

**Title** ***An Examination of Religion and Spiritual Variables that Predict Overall Health and Perception of Physical Pain***

Ruth P Dennison-Tedesco, Joseph W Ciarrocchi (*Loyola College in Maryland*)  
Gina M Yanni-Brelsford (*Penn State University*)

**Title** ***Self-Control: Does Being Spiritual or Religious Make a Difference?***

Joanne Comstock, Joseph W Ciarrocchi (*Loyola College in Maryland*)  
Gina M Yanni-Brelsford (*Penn State University*)  
Deborah Rollison (*Loyola College in Maryland*)

---

<http://www.apa.org/>

115th Annual Convention  
San Francisco - August 17-20, 2007

March 15, 2007 - Online registration begins.  
<http://www.apa.org/convention07/>

---

## FRIDAY - MARCH 2

### Speakers and Presentations

**Session Name:** Children and Adolescents Spiritual Growth  
**Session Number:** 107  
 3:00 pm                      3:50 pm    Room 262                      *Event Paper Session*

**Title**        *The Relationship of Religious and Spiritual Struggle With Adjustment to College Among Children of Missionaries*  
                   Brent Bounds (Fordham University)

**Title**        *Encouraging Children's Spiritual Intelligence*  
                   Molly A Painton (The Interplay Center and Spirit Play Institute)

**Title**        *Punk Rock and the Spiritual Pilgrimage*  
                   Scott D Reeder (University of North Carolina)

**Session Name:** Spiritual Predators: The Growth of Destructive and Aggressive Cults and Missions and its Impact on Making Informed Spiritual Choices  
**Session Number:** 108  
 3:00 pm                      3:50 pm    Room 261                      *Event Paper Session*

**Title**        *Spiritual Predators: The Growth of Destructive and Aggressive Cults and Missions and its Impact on Making Informed Spiritual Choices*  
                   Scott Hillman (Jews for Judaism)

**Session Name:** Spiritual Issues in Psychotherapy and Promoting Positive Change  
**Session Number:** 109  
 3:00 pm                      4:20 pm    Room 271                      *Event Paper Session*

**Title**        *A Christian Spirituality and Psychotherapy: Reflection on a Gay Christian Psychologist's Experience*  
                   Richard H York (Private Practice)

**Title**        *Buddhist Compassion Meditation for Non-Buddhists: Promoting Positive Change Through Time-Tested Strategies*  
                   Brian H McCorkle, Susan deHoff, Colleen Roos, Angela Wilson  
                   Emily Culler (Boston University)

**Volume  
#17  
2006**

**NOW AVAILABLE**

*“Research in the Social  
Scientific Study of Religion”*

*Editor: Ralph Piedmont*

*Brill Publishing - <http://www.brill.nl/>*

## FRIDAY - MARCH 2

### Speakers and Presentations

**Session Name:** Thematic Analyses of Trends and Controversies  
in the Psychology of Religion

**Session Number:** 110

3:30 pm

4:50 pm

Room 272

**Event** Paper Session

**Title** *A Thematic Overview of the Recent History Between Psychology and Religion*

C Kevin Gillespie (*Loyola College in Maryland*)

**Title** *By Its Fruits?: The Pragmatics of Contemporary Psychology of Religion*

Leonard M Hummel (*The Lutheran Theological Seminary*)

**Title** *The Psychology of Religion: Does it Explain Religion or Just Explain It Away?*

M Chet Mirman (*Argosy University*)

**Session Name:** Spiritual Adjustment Across the Life Span

**Session Number:** 111

4:00 pm

4:50 pm

Room 270

**Event** Paper Session

**Title** *Health, Religiousness, Spirituality - Aging Wine/Newer Wineskins?*

Carole A Rayburn (*Independent Practice*)

**Title** *The Concept of Spiritual Injury and Its Increasing Importance Counseling and Research*

Oscar C Stine, Donald LaFaber, Steven Jenks

(*Veterans Affairs Medical Center*)

Hugh Maddy (*VA Chaplain Services*)

**Title** *Santification of the Body as a Protective Factor in Health Risk Behaviors in College Students*

Erica L Swenson (*University of Connecticut*)

Crystal L Park (*University of Connecticut*)

Raymond F. Paloutzian (*Westmont College*)

**Session Name:** Invited Address

**Session Number:** 112

4:00 pm

4:50 pm

Room 360/362

**Event** Invited Address

**Title** *On the Limits of Scientific Investigation: Miracles*

Richard Gorsuch (*Fuller Theological Seminary*)

## FRIDAY - MARCH 2

### Speakers and Presentations

**Session Name:** Personality Correlates of Spirituality  
**Session Number:** 113  
 4:00 pm 4:50 pm Room 262 **Event** Paper Session

**Title** *Narcissistic Tendencies In Relation to Religion According to Fowler's Stages of Faith*  
 Chris Coultas, Jessica Hill, Sarah Ignacio, Fred Volk, Aaron Lawler  
 Daniel Ryan (*Liberty University*)

**Title** *The Big Five and the Spiritual Six: Examining Religious and Personality Parallels In the Spiritual Assessment Inventory and the NEO Five Factor Inventory*  
 Shawn W Hales, Sara Leven (*Loyola College in Maryland*)

5:15 pm 7:15 pm **Gala Reception**  
 Room 210/230

## SATURDAY - MARCH 3

### Speakers and Presentations

**Session Name:** The Psychological and Spiritual Landscape of Clergy Sexual Abuse  
**Session Number:** 114  
 10:00 am 10:50 am Room 260 **Event** Symposium

**Title** *Clergy Sexual Abuse: The Prevalence, Scope, and Implications*  
 Mary-Marguerite Kohn, Nichole A. Murray-Swank  
 (*Loyola College in Maryland*)

**Title** *Sacred Betrayal: The Role of Spirituality in the Lives of Survivors of Clergy Sexual Abuse*  
 Nichole A. Murray-Swank, Mary-Marguerite Kohn, Mary Liz Austin  
 Melynda Klausner (*Loyola College in Maryland*)

Mid-Year Conference \_\_\_\_\_  
 Headquarter Hotels



<http://marriott.com/property/propertypage/BWICL>

<http://www.extendedstayamerica.com/>



## SATURDAY - MARCH 3 Speakers and Presentations

**Session Name:** Hope Self-Determination, and Health  
**Session Number:** 115  
10:00 am 10:50 am Room 272 **Event** Symposium

**Title** **Hope, Self-Determination and Health**  
Erica R Checko (*University of Rhode Island*)  
Anthony Scioli (*Keene State College*)  
**Title** **Hope, Health and HIV**  
Anthony Scioli (*Keene State College*)  
Susan McNeil, Vanessa Partridge (*AIDS Service for the Monadnock Region*)

**Session Name:** Invited Address  
**Session Number:** 116  
10:00 am 10:50 am Room 360/362 **Event** Invited Address

**Title** **Keeping an Open Heart in Troubled Times: Self-Empathy as a Christian Spiritual Practice**  
Deborah van Deusen-Hunsinger (*Princeton Theological Seminary*)

**Session Name:** Invited Address  
**Session Number:** 117  
11:00 am 11:50 am Room 360/362 **Event** Invited Address

**Title** **Psychophysiological Reactivity to Stress: A Possible Bridge Between Religion and Health**  
Kevin Masters (*Syracuse University*)

SUPPORT  
OUR **E** xhibitors

Second Floor Lobby and Room 259

**SATURDAY - MARCH 3**  
**Speakers and Presentations**

**Session Name:** Cross Cultural Issues in the Psychology  
of Religion

**Session Number:** 118

11:00 am 11:50 am Room 260

**Event** Paper Session

**Title** *The Role of Spirituality in Developing a Positive Cultural Identity:  
Implications for Teaching and Learning*

Elizabeth J Tisdell (Penn State University)

**Title** *No Religion in Fordyce's Happiness. As Psychology Students Says In  
Northeast Mexico*

Alejandro Tapia-V, Paola Gonzalez, Cristina Delgado  
(Universidad de Monterrey)

**Title** *Trauma and Claims of Memories of a Past Life: Psychological Studies  
of Children in Sri Lanka and Lebanon*

Erlendur Haraldsson (University of Iceland)

**Session Name:** Issues in Forgiveness

**Session Number:** 119

11:00 am 11:50 am Room 271

**Event** Paper Session

**Title** *Unforgiveness and Increased Risk of Cardiovascular Health Problems  
in a Nationally Representative, Probability Sample of United States Adults*

Loren Toussaint, Alyssa Cheadle (Luther College)

**Title** *Interpersonal Forgiveness: A Linguistic Analysis of the Process*

Mark M Leach (University of Southern Mississippi)

**book**  
**Sales**  
**room 259**  
and second floor lobby

## SATURDAY - MARCH 3

### Poster Sessions

**Session Name:** Poster Session I  
**Session Number:** 120  
 11:00 am 12:30 pm Room 210/230 **Event Poster**

- Title** *Adult Attachment Style, Personality Traits and Cognitive Style as Predictors of Religious Orientation: The Moderating Role of Gender and Race*  
 James R Stefurak (Auburn University Montgomery)
- Title** *Change in Religious and Spiritual Meaning after Bereavement: Qualitative Evidence for the Meaning-Making Framework*  
 Jennifer Wortmann, Crystal L. Park (University of Connecticut)
- Title** *Goodbye My Fancy: Walt Whitman: The Poet of Death*  
 Meghan Miller (Adelphi University)
- Title** *Thank You: A Buddhist Perspective on the Self and Gratitude*  
 Maureen A Mathews, Jeffrey D Green (Virginia Commonwealth University)
- Title** *The Effect of Spirituality and Campus Ministry Involvement on Academic Accomplishment in College Students*  
 Jessica Schubmehl, Stephen Cubbellotti, William Van Ornum  
 (Marist College)
- Title** *Understanding the Basis of Attitudes Toward Women Pastors in Puerto Rico*  
 Zorangeli Ramos, Richard Gorsuch (Fuller Theological Seminary)

12:00 am 1:30 pm **Panera Bread Lunch**  
 3rd Floor Student Lounge, Rooms 330 & 304

Schedule your next  
**Meeting, Training, Seminar or Conference**

at Loyola's Beautiful, Lakeside  
**Columbia Graduate Center**

- Professional Environment
- Exceptional Service
- Convenient Location
- Spacious Rooms
- Integrated Technology



*Experience the Loyola Difference!*

Loyola College, Columbia Graduate Center  
 8890 McGaw Road, Columbia, MD, 21045

[www.loyola.edu/columbia](http://www.loyola.edu/columbia) 410-617-7601

## SATURDAY - MARCH 3

### Poster Sessions

**Session Name:** Poster Session II  
**Session Number:** 121  
12:30 pm 2:00 pm Room 210/230 **Event Poster**

- Title** *A Comparison of Hope and Optimism With Spirituality and Their Relationships to Prosocial Behavior, Satisfaction with Life, and Death Anxiety*  
Ruth P Dennison-Tedesco, Ralph Piedmont (Loyola College in Maryland)
- Title** *Analysis of the Contribution of Religious Scales Over Personological Outcomes*  
Joseph E G Williams (Eastern Illinois University)
- Title** *Changes with Aging of the Association of Religiosity and Current Alcohol Use in Americans Aged 17 to 90 in a National Survey*  
Sayidda Martin (Howard University Hospital)
- Title** *Dimensions of Religiosity and Cigarette Smoking During Pregnancy in American Women*  
R F Gillum (National Center for Health Statistics)
- Title** *Guidelines for Assessing Client Spirituality in Counseling*  
Innocent F Okozi, Sandra Lee (Seton Hall University)
- Title** *Religiosity and Spiritual Disclosure in College Couples' Relationship Satisfaction*  
Chelsea a Hetrick, Chris J Boyatzis (Bucknell University)
- Title** *The Impact of Social Support, Spirituality, and Extraversion on Grief Symptoms in Women Religious: A Longitudinal Examination*  
Donna Kelley (Loyola College in Maryland)
- Title** *Cognitive Mediation Deficits in Sexually Offending and Non-Offending Roman Catholic Clergy and the Relationship of Stress*  
Gregory P Ryan (Loyola College in Maryland)  
Jeffrey P Baerwald (Santa Clara University)
- Title** *The Relationship Between Religiosity (Spirituality) and Marital Satisfaction: A Field Study on a Kuwaiti Sample*  
Humoud Alqashan (Kuwait University)

---

---

Graduate Programs in  
**Pastoral Counseling and  
Spiritual Care**



<http://www.loyola.edu/pastoralcounseling>  
8890 McGaw Road Columbia MD 21045  
P: 410-617-7620 Fax:410-617-7644

---

---

## SATURDAY - MARCH 3

### Speakers and Presentations

**Session Name:** Forgiveness, Gratitude, Appreciation, Mental and Biopsychosocial Health in Clinical, College Student and National Adult Populations

**Session Number:** 122

1:00 pm

2:20 pm

Room 271

**Event** Symposium

**Title** *Forgiveness, Gratitude, Appreciation and Mental Health in a Clinical Population*

Philip H Friedman (*Foundation for Well-Being*)

**Title** *Forgiveness and Mental Health in a Nationally Representative, Probability Sample of United States Adults*

Loren Toussaint, Alyssa Cheadle (*Luther College*)

**Title** *Forgiveness and Biopsychosocial Health Among College Students*

Jon R Webb (*East Tennessee State University*)

Ken Brewer (*Northeast State Technical Community College*)

**Session Name:** Trauma and Spirituality: The Recursive Nature of Spiritual Meaning and Meaning Making

**Session Number:** 123

1:00 pm

2:20 pm

Room 260

**Event** Symposium

Mark Koltko-Rivera, Discussant

**Title** *The Impact of Highly Stressful Events on Religiousness/Spirituality and Subsequent Coping*

Crystal L Park (*University of Connecticut*)

**Title** *The Cumulative Effect of Traumatic Events on Religious Meaning Systems*

Mary Alice Mills (*University of Connecticut*)

**Title** *Religious Meaning Influences the Cognitive Response to Cancer, and Vice Versa*

Donald Edmondson (*University of Connecticut*)

**Session Name:** Invited Address

**Session Number:** 124

1:00 am

1:50 am

Room 360/362

**Event** Invited Address

**Title** *Dimensions of Spiritual and Religious Engagement*

Jean L. Kristeller

## **SATURDAY - MARCH 3**

### **Speakers and Presentations**

**SATURDAY - March 3, 2007**

<b>Session Name:</b>	<b>Invited Address</b>		
<b>Session Number:</b>	<b>125</b>		
2:00 pm	2:50 pm	Room 360/362	<b>Event</b> <i>Invited Address</i>

**Title**      ***The Contemporary Christian Serpent Handlers of Appalachia***  
                  Ralph W Hood (*University of Tennessee*)

<b>Session Name:</b>	<b>Spirituality and Mental and Physical Health</b>		
<b>Session Number:</b>	<b>126</b>		
2:30 pm	3:50 pm	Room 271	<b>Event</b> <i>Paper Session</i>

**Title**      ***Life-Changing Spiritual/Religious Experiences in Alcoholics and Their Association with Reduced Drinking***

Elizabeth A R Robinson, Amanda M Price (*University of Michigan*)

**Title**      ***The Impact of Religious Belief on Response to Treatment for Clinical Depression: A Longitudinal Analysis***

Patricia Murphy, George Fitchett (*Rush University Medical Center*)

**Title**      ***Spiritual Well-Being and Acceptance of Disability: A Study of Life Satisfaction in People with Neuromuscular Diseases***

Roy K Chen, Euchay Horsman (*University of Texas-Pan American*)

**Title**      ***Frequency of Attendance at Religious Services and Survival in a US National Cohort Aged 40 and Over***

P Summers (*Howard University*)

<b>Session Name:</b>	<b>Spiritual Techniques for Growth</b>		
<b>Session Number:</b>	<b>127</b>		
2:30 pm	3:50 pm	Room 262	<b>Event</b> <i>Paper Session</i>

**Title**      ***Spiritually Based Mood Induction and its Affect on Cognitive Functioning***

Kevin D Jordan, Patrick Steffen (*Brigham Young University*)

**Title**      ***Inward, Outward, Upward Prayer: Practices of "Spiritual", "Religious", and "Both" Respondents***

Kevin L Ladd (*Indiana University South Bend*)

**Title**      ***Moral Emotions and Spiritual Transformation: Shifting the Paradigm from Meaning-System to Moral Motive Analyses***

G Michael Leffel (*Point Loma Nazarene University*)

**SATURDAY - MARCH 3**  
**Speakers and Presentations**

**Session Name:** Images of God, Spiritual Attachment, and Subjective Well-Being in Adult Victim of Child Abuse: Diverse Forms, Diverse Outcomes, and Diverse Populations  
**Session Number:** 128  
 3:00 pm 3:50 pm Room 260 **Event** Symposium

- Title** **Child Abuse, Personality, and Spirituality as Predictors of Happiness in Maltese College Students**  
 Joseph W Ciarrocchi, Robert J Wicks, Michael Galea  
 (Loyola College in Maryland)
- Title** **Childhood Trauma, Attachment to God, and Subjective Well-Being in a Clinical Sample**  
 Stephanie Van Deusen, Joseph W Ciarrocchi, Nancy Jo Scheers  
 Christine Courtois (Loyola College in Maryland)
- Title** **The Relationship Between Spirituality and Subjective Well-Being on Adult Victims of Childhood Bullying: Evidence for a Buffering Effect for Image of God**  
 Erin Deneke, Joseph Ciarrocchi, Sharon Cheston, Lee Richmond  
 (Loyola College in Maryland)

**Session Name:** Working with Orthodox Jewish Clients  
**Session Number:** 129  
 3:00 pm 4:50 pm Room 272 **Event** Paper Session

- Title** **Secular Analyst - Ultra- Orthodox Patient: Transference-Countertransference Dynamics**  
 Martin A Schulman (Essex County College)  
 Ricki S Kaplan (National Psychological Assoc. for Psychoanalysis)
- Title** **Measuring Religiosity in English -Speaking Orthodox Jews**  
 Erez Harari, John Cecero (Fordham University)

**CONTINUING EDUCATION Workshop**  
 Pastoral Counseling Department, Loyola College in Maryland

April 27, 2007  
 To Register contact  
 Monique Daniels  
 mcdaniels@loyola.edu  
 410-617-7608

**Crazy Love**

**Dealing with Your Partner's Problem Personality**

based on a book by W. Brad Johnson, Ph.D., and Kelly Murray, Ph.D. Available April 2007

## SATURDAY - MARCH 3

### Speakers and Presentations

**Session Name:** Visions in Conflict II  
**Session Number:** 130  
3:00 pm 4:50 pm Room 360/362 **Event** Symposium

Brian Alston - Moderator

**Title** **Communications and Conflict: Can American Psychology Speak to the Ethnic Groups of Burma**

Richard Gorsuch (Fuller Theological Seminary)

**Title** **Conflict Resolution in Muslim-Majority Societies**

Haroon Ullah (The Institute for Social Policy and Understanding)

**Title** **Neighbors, strangers, enemies friends: Religious Constructs of the "other"**

William R Clough (Argosy University)

**Title** **Spiritual Awareness: Conflict as Harming the Fabric of the Universe**

Lisa Miller (Columbia University)

#### **A Message from the Conference Director Ralph L. Piedmont, Ph.D.**



*Greetings and welcome to the Annual Mid Year Research Conference on Religion and Spirituality.*

*This marks the 5<sup>th</sup> year that the Department of Pastoral Counseling at Loyola College and Division 36 (Psychology of Religion) of the APA have joined in offering this event. However, this is the 13<sup>th</sup> year of this conference.*

*It originally began as a small roundtable, literally. In 1995, 15 students and faculty sat around a table to discuss contemporary issues in the field for a morning. Eventually the "Roundtable", as it was known, grew into a half day event that included several invited speakers. In 2003, it was expanded into a 2 day event and included a new partner, Division 36.*

*Today, the conference is 3 days in length and includes numerous CEU opportunities through clinical workshops and a variety of symposia and paper sessions. Nationally and internationally known speakers come to share their expertise with attendees on a variety of cutting-edge issues. Over 300 people attended the conference last year and we are hoping for even more this year. This conference has grown to attract the attention of researchers from around the globe, including presenters this year from Mexico, Kuwait, and Iceland. We are also privileged to have many first time student presenters and conference attendees. We welcome you and hope that this experience is your first of many positive interactions with professional conferences.*

*Of course, none of this would have happened without your support and involvement. This conference is unique in that it represents the only research-based event in the area of religion and spirituality. Your presence helps supports the work of the many presenters who come here to share their ideas and develop their thinking. The conference provides a comfortable, stimulating environment to discuss issues in this field with individuals from diverse faith groups, professional orientations, and theoretical perspectives.*

*On behalf of the Pastoral Counseling Department and Division 36, I hope that you will enjoy your time at the conference. I also hope that you will join us again next year.*

*Ralph*

## Invited Speaker Biographies

### **Richard Gorsuch, Ph.D.**

**On the Limits of Scientific Investigation: Miracles**



Richard Gorsuch is a prolific researcher, best known for his studies in research methods and psychology of religion.

A Senior Professor of Psychology at the Graduate School of Psychology, Fuller Theological Seminar, his major books include *Factor Analysis* (2nd edition) and the *Psychology of Religion: An Empirical Approach* (Spilka, Hood, Hunsberger, and Gorsuch).

His most recent book, *Integrating Psychology and Spirituality?*, will be available in paperback, spring, 2007. He is a fellow of the Society for the Scientific Study of Religion and Divisions 36 and 5 of APA

### **Ralph W. Hood, Jr., Ph.D.**

**The Contemporary Christian Serpent Handlers of Appalachian**



Ralph W. Hood Jr. is professor of psychology at the University of Tennessee at Chattanooga. He is a past president of the division of the Psychology of Religion of the American Psychological Association and a recipient of its William James Award.

He is a former editor of the *Journal for the Scientific Study Religion* and a former co-editor of *The International Journal for the Psychology of Religion*. He is currently a co-editor of the *Archiv für Religionpsychologie*.

He has published hundreds of papers on the psychology of religion and has authored, co-authored and edited nine books. Of most relevance to his talk is, *Handling Serpents: Pastor Jimmy Morrow's Narrative History of his Appalachian Jesus' Name Tradition* published by Mercer University Press, 2003.

### **Roland R. Griffiths, Ph.D.**

**Psilocybin and the Frontier of Experimental Mysticism**



Roland R. Griffiths Ph.D., is Professor in the Departments of Psychiatry and Neurosciences at the Johns Hopkins University School of Medicine.

His principal research focus in both clinical and preclinical laboratories has been on the behavioral and subjective effects of mood-altering drugs. His research has been largely supported by grants from the National Institute on Health and he is author of over 300 journal articles and book chapters.

He has been a consultant to the National Institutes of Health, and to numerous pharmaceutical companies in the development of new psychotropic drugs. He is also currently a member of the Expert Advisory Panel on Drug Dependence for the World Health Organization. He has an interest in meditation and is Principal Investigator of the psilocybin research initiative at Johns Hopkins.

### **Jean Kristeller, Ph.D.**

**Dimensions of Spiritual and Religious Engagement**



Dr. Kristeller is a clinical and psychologist whose primary focus of research has been on self-regulatory processes of emotion and health.

She was been engaged in research on the role of religiousness and spirituality in adjustment to cancer, and in modulating drinking behavior in college students (with her colleague Dr. Tom Johnson). She has also conducted research on various aspects of meditation practice for most of her career, including physiological, emotional, behavioral and spiritual effects.

Her research on spirituality and meditation-based treatment of eating disorders/obesity has been supported by funding from the Metanexus Institute and the NIH National Center for Complementary and Alternative Medicine. She has recently received funding for a national research conference on meditation and spirituality.

She holds a doctorate in clinical psychology from Yale University, and has been on the staff of the Behavioral Medicine services at Cambridge Hospital and the Univ. of Massachusetts Medical School.

She has also traveled and worked extensively in Asia, including Japan, Thailand, and Indonesia.

## Invited Speaker Biographies

### **Deborah van Deusen Hunsinger, Ph.D.**

**Keeping an Open Heart in Troubled Times: Self-Empathy as a Christian Spiritual Practice**



Deborah van Deusen Hunsinger, Ph.D. is associate professor of pastoral theology at Princeton Theological Seminary. A Fellow in the American Association of Pastoral Counselors, she worked as a practicing pastoral counselor for nearly 15 years before she began full-time teaching in 1993.

Deborah earned her M.Div. from Yale University Divinity School, and her M.Phil. and Ph.D. from Union Theological Seminary in New York City in the program of psychiatry and religion.

An ordained Presbyterian minister, she is interested in educating clergy and laypeople to offer theologically sound and psychologically informed pastoral care in the church. Her first book, *Theology and Pastoral Counseling: A New Interdisciplinary Approach* (Wm. B. Eerdmans, 1995) investigated key conceptual issues in the interdisciplinary relationship between theology and depth psychology in the specialized ministry of pastoral counseling.

After she began teaching at Princeton Seminary; her interests gravitated toward the pastoral care of congregations. Her second book, *Pray without Ceasing: Revitalizing Pastoral Care* (Wm. B. Eerdmans, 2006) came out last August. Arguing that prayer is the very heart of the church's life together, the book seeks to assist in revitalizing congregations through practices of mutual pastoral care.

In the past few years, Deborah has undergone intensive training in Nonviolent Communication (NVC), a mode of consciousness and set of skills that promote compassionate and honest relationships, which she has adapted for work in the church. NVC was created by Marshall Rosenberg more than 40 years ago and has been developed in various contexts by a variety of psychologists, educators, trainers, and social activists.

It is now an international training and peacemaking organization that facilitates connection and mutual respect among individuals, groups and even representatives of nations at war. Her lecture at this conference comes out of the profound impact NVC has had in her life and teaching.

She is married to theologian, George Hunsinger, who also teaches at Princeton Theological Seminary and is founder of the National Religious Campaign Against Torture. They have two grown daughters and two granddaughters.

### **Kevin Masters, Ph.D.**

**Psychophysiological Reactivity to Stress: A Possible Bridge Between Religion and Health**



Dr. Kevin Masters is Associate Professor of Psychology and Director of Clinical Training at Syracuse University in Syracuse, NY.

He also holds an appointment in the Department of Psychiatry at SUNY – Upstate Medical University and is a member of the Center for Health and Behavior at Syracuse University and the Center for Integrated Healthcare sponsored by the Veterans Administration.

Dr. Masters serves as Associate Editor of the *Journal of Behavioral Medicine*, Editor of the *Health Psychologist*, and as a reviewer for the annual conventions of the American Psychological Association (Division 38) and the Society of Behavioral Medicine as well as numerous professional journals.

He is currently co-chair of a task force sponsored by Division 38 of APA to explore models of training in health psychology and he is actively involved with the Syracuse University Spirituality Research Group, an interdisciplinary team of scholars probing the meaning and effects of spirituality among college students.

Dr. Masters first published research on religion and psychological health while working in the laboratory of Dr. Allen Bergin in the late 1980's. His interests have since developed to include investigations of religion and cardiovascular health and he recently published a meta-analysis on distant intercessory prayer and healing along with general reviews on prayer and health.



## Invited Speaker Biographies

### **William A. Richards, Ph.D.**

**Psilocybin and the Frontier of Experimental  
Mysticis**

William A. Richards is a psychologist in the Psychiatry Department of the Johns Hopkins



University School of Medicine, Bayview Medical Center, currently pursuing research with entheogens, and also a clinician in private practice in Baltimore

His graduate degrees include M.Div. from Yale Divinity School, S.T.M. from Andover-Newton Theological School and Ph.D. from Catholic University, as well as studies with Abraham Maslow at Brandeis University and with Hanscarl Leuner at Georg-August University in Göttingen, Germany, where his involvement with psilocybin research originated in 1963.

From 1967 to 1977, he pursued psychotherapy research with LSD, DPT, MDA and psilocybin at the Maryland Psychiatric Research Center, including protocols designed to investigate the promise of entheogens in the treatment of alcoholism, severe neuroses, narcotic addiction and the psychological distress associated with terminal cancer, and also their use in the training of religious and mental-health professionals. From 1977-1981, he was a member of the psychology faculty of Antioch University in Maryland.

His publications began in 1966 with "Implications of LSD and Experimental Mysticism," coauthored with Walter Pahnke, and published in the Journal of Religion and Health.

### **Visions in Conflict**

**Presenters**

**Brian Alston - Moderator** - Doctoral student Clinical Psychology Argosy University, STM Boston  
University School of Theology, MA Hartford Seminary

**Susan E. Hawes, Ph.D.** Professor, Clinical Psychology  
Antioch University New England.

**Steven Handwerker, Ph.D., D.Div.** Founder and Chairman of the International Association for the Advancement of Human Welfare, Board Certified Licensed Psychologist. Board Certified Member of The Professional and Scientific Board of the American Academy of Experts in Traumatic Stress.

**William R. Clough, D.Min.** Associate Professor Program Chair, Pastoral Community Counseling Program Argosy University, Sarasota.

**Cathy O'Keefe, M.Ed.**, Certified Therapeutic Recreation Specialist and Senior Instructor University of South Alabama Department of Health, Physical Education, and Leisure Studies Mobile, AL 36688

**Lisa Miller, Ph.D.** Associate Professor of Psychology and Education, Teachers College, Columbia University, President-Elect, APA Division 36

**Abdullah Hassan, MD** President of Muslim Mental Health, Inc. Staff psychiatrist and unit chief at Long Island Jewish Hospital in New York City. Political Science Scholar of the Institute of Social Policy and Understanding (ISPU).

**Richard Gorsuch, Ph.D., MDiv** Senior Professor of Psychology Graduate School of Psychology Fuller Theological Seminary

**Haroon Ullah**, Doctoral Student, Political Science and Public Policy, The Institute for Social Policy and Understanding.



## Index of Presenters

Austin	Mary Liz	114	Maddy	Hugh	111
Baerwald	Jeffrey P	121	Marinelli	Stephanie B	106
Bounds	Brent	107	Martin	Sayidda	121
Boyatzis	Chris J	121	Masters	Kevin	117
Brewer	Ken	122	Mathews	Maureen A	120
Buckley	James	106	McCorkle	Brian H.	109
Bughar	Desmond	106	McNeil	Susan	115
Carney	Caren M	105	Miller	Lisa	130
Cecero	John	129	Miller	Meghan	120
Cheadle	Alyssa	122, 119	Mills	Mary Alice	123
Checko	Erica R	115	Mirman	M. Chet	110
Chen	Roy K.	126	Murphy	Patricia	126
Cheston	Sharon	128	Murray-Swank	Nichole A.	114
Ciarrocchi	Joseph W	128, 106	Obisesan	Thomas	102
Clough	William R.	130	O'Keefe	Catherine	104
Comstock	Joanne	106	Okozi	Innocent F.	121
Cosenza	Anthony	101	Painton	Molly A.	107
Coultas	Chris	113	Paloutzian	Raymond F.	111
Courtois	Christine	128	Park	Crystal L	123, 111, 120
Courville	William J	105	Partridge	Vanessa	115
Cubbellotti	Stephen	120	Piedmont	Ralph	128, 121
Culler	Emily	109	Portafoglio	Anthony	101
deHoff	Susan	109	Price	Amanda M.	126
Delgado	Cristina	118	Ramos	Zorangeli	120
Deneke	Erin	128	Raudenbush	Linda	105
Dennison-Tedesco	Ruth P	106, 121	Rayburn	Carole A.	111
Dupree	Natalie	102	Reeder	Scott D.	107
Dy-Liacco	Gabriel	106	Richards	Bill	103
Edmondson	Donald	123	Richmond	Lee	128
Finer	Lawrence B	102	Robinson	Elizabeth A. R.	126
Fitchett	George	126	Rollison	Deborah	106
Friedman	Philip H	122	Roos	Colleen	109
Galea	Michael	128	Ryan	Gregory P	121
Gillespie	Kevin C.	110	Ryan	Daniel	113
Gillum	R.F.	102, 121	Scheers	Nancy Jo	128
Gonzalez	Paola	118	Schubmehl	Jessica	120
Gorsuch	Richard	120, 130, 112	Schulman	Martin A.	129
Green	Jeffrey D	120	Scioli	Anthony	115
Griffiths	Roland	103	Scriber	Clarice L	105
Hales	Shawn W.	113	Shannon	Donna	106
Handwerker	Steven	104	So	Dominicus	102
Haraldsson	Erlendur	118	Steele	Lanor	101
Harari	Erez	129	Steffen	Patrick	127
Hasan	Abdullah	104,	Stefurak	James R	120
Hawas	Susan E.	104	Stine	Oscar C.	111
Hetrick	Chelsea a	121	Summers	P	126
Hill	Jessica	113	Swenson	Erica L.	111
Hillman	Scott	108	Tapia-V	Alejandro	118
Hood	Ralph W.	125	Thukral	Rajat	106
Horsman	Euchay	126	Tisdell	Elizabeth J.	118
Hummel	Leonard M.	110	Toussaint	Loren	122, 119
Ignacio	Sarah	113	Trulear	Harold Dean	102
Jenks	Steven	111	Ullah	Haroon	130
Jones	Jo	102	Van Deusen	Stephanie	128
Jordan	Kevin D.	127	van Deusen-Hunsinger	Deborah	116
Kaplan	Ricki S.	129	Van Ornum	William	120
Kelley	Donna	121	Volk	Fred	113
Klausner	Melynda	114	Webb	Jon R	122
Kohn	Mary-Marguerite	114	Wicks	Robert J	128
Koltko-Rivera	Mark	123	Williams	Joseph E. G.	121
Kristeller	Jean	124	Wilson	Angela	109
Ladd	Kevin L.	127	Wortmann	Jennifer	120
LaFaber	Donald	111	Yanni-Brelsford	Gina M.	106
Lawler	Aaron	113	York	Richard H	109
Leach	Mark M.	119			
Lee	Sandra	121			
Leffel	G. Michael	127			
Leven	Sara	113			

# ***Division 36: Psychology of Religion*** ***American Psychological Association***

## ***Background:***

Division 36 of the American Psychological Association, *Psychology of Religion*, brings together psychologists who recognize the significance of religion both in the lives of people and to the discipline of psychology. The division is nonsectarian. Membership and division activities are open to members of all faiths as well as to those who are not religiously affiliated or do not profess a particular personal faith commitment.

The organization was established originally in 1949 as the *American Catholic Psychological Association (ACPA)*. In 1970 it was renamed *Psychologists interested in Religious Issues (PIRI)*, and in 1976 PIRI officially became Division 36 of the APA.

In 1993, by vote of the membership, the division was renamed *Psychology of Religion*. We are indebted to that farsighted group of ACPA members who recognized that mainstream psychology did not have an organization through which psychologists could easily express their interests in the psychology of religion.

This area is one of the oldest in psychology; research on religion development and experience was conducted over a century ago, and both William James and G. Stanley Hall were leading psychologists of religion. Division 36 is working to re-establish the scientific psychology of religion to the respected status it once held so firmly in our discipline.

A wide variety of psychological interests and activities exist among the members of the division. Members work in virtually every area, from experimental and statistical research to clinical work with children and adults. We are concerned with both the scientific and applied aspects of our field.

Many members do research exclusively on issues in the psychology of religion; others bring this interest to bear on a variety of allied areas in psychology. Our professional affiliates may be found working in sociology, religious studies, and other social sciences. Some members also possess clerical degrees, and integrate psychology with the requirements of a pastoral life as researchers and practicing clinicians.

The psychology of religion is integral to understanding human behavior in the widest possible sense. As a division of APA, our basic role is to show how the psychological study of religion contributes to a scientific understanding of human nature.

## ***Purpose:***

The purpose of Division 36 is twofold:

1. To encourage the development of research, theory, and practice in the psychology of religion and related areas; and,
2. To facilitate the dissemination of research data on religious and allied issues, and effect the integration of these data with current psychological research, theory, and practice.

## ***Membership:***

You may apply for membership in Division 36 at a level consistent with your status in APA. Members, associates, and fellows of APA are eligible for Division 36 members, associate, and fellow status, respectively. Student affiliates of APA may apply for student affiliate status in the Division as well. Nonmembers of APA may apply for professional affiliate status. Applications for this status must meet the eligibility requirements for membership in APA and be approved by the Division's Executive Committee.

Membership includes a number of benefits, including the division newsletter, reduced registration fees for the Mid Year Research Conference, reduced subscription prices for select journals in the field, and professional contacts in our field. Most valuable are opportunities for participating in the annual convention and divisional affairs. These allow a kind of personal and intellectual stimulation not available elsewhere.

If you share our concerns and interests, we encourage you to join us! For more information and an application, contact the Membership Chair:

William Hathaway, Ph.D.  
Regent University  
1000 Regent University Drive  
Virginia Beach, VA 23464  
phone: 757-226-4294  
fax: 757-226-4303  
e-mail: willhat@regent.edu

## Academic Programs

Academic Programs include the PhD in Counseling Psychology and Religion in Boston University's Division of Religious and Theological Studies. This doctoral program is ASPPB designated. Additionally, the Institute's funding of pastoral care programs include courses for MDiv, MTS, MST, DMin, and ThD students in the Boston University School of Theology, all aiming to enhance ministry with advanced knowledge in psychology and psychotherapy, closely connected with spiritual formation. **For more information, contact Chris Schlauch, MDiv, PhD, at [crschlau@bu.edu](mailto:crschlau@bu.edu).**



## **The Albert & Jessie Danielsen Institute at BOSTON UNIVERSITY** **[www.bu.edu/danielsen](http://www.bu.edu/danielsen)**

**185 Bay State Road  
Boston, MA 02215  
617.353.3047  
617.353.5539 (fax)**

## Research

The Center for the Study of Religion & Psychology conducts research projects at the intersection of religious and spiritual life with psychological inquiry, always aiming to relieve human suffering and promote human growth. This research involves both empirical and humanistic approaches, and takes advantage of the location of the Danielsen Institute within a large research university that includes graduate programs in comparative religion, theology, psychology, neuroscience, counseling, social work, psychiatry, sociology, and education. **For more information, contact Brian McCorkle, PhD, at [mccorkle@bu.edu](mailto:mccorkle@bu.edu).**

## Outpatient Clinic

The Danielsen Clinic is a multidisciplinary mental health clinic licensed by the Massachusetts Department of Public Health. It offers psychotherapy, psychiatry, assessments, and consultation services that attend to all dimensions of a client's personhood, including spirituality and religious faith should the client so desire. The Danielsen Clinic is accredited as a service center by the American Association of Pastoral Counselors, and is affiliated with the Samaritan Institute. **For more information, contact George Stavros, MDiv, PhD, at [stavros1@bu.edu](mailto:stavros1@bu.edu).**

## Clinical Training

The Danielsen Institute offers several clinical training programs: a practicum-level training program for Boston University students in Social Work, Clinical Psychology, and Counseling Psychology and Religion; an APA-approved psychology internship training program; an advanced social work training program for LCSWs; and a limited postdoctoral psychology program that includes clinical and research positions. These programs train clinicians and researchers who can attend to the interface between spirituality and psychotherapy. **For more information, contact David Rupert, PsyD, at [drupert@bu.edu](mailto:drupert@bu.edu).**

# Building Floorplan

## First Floor

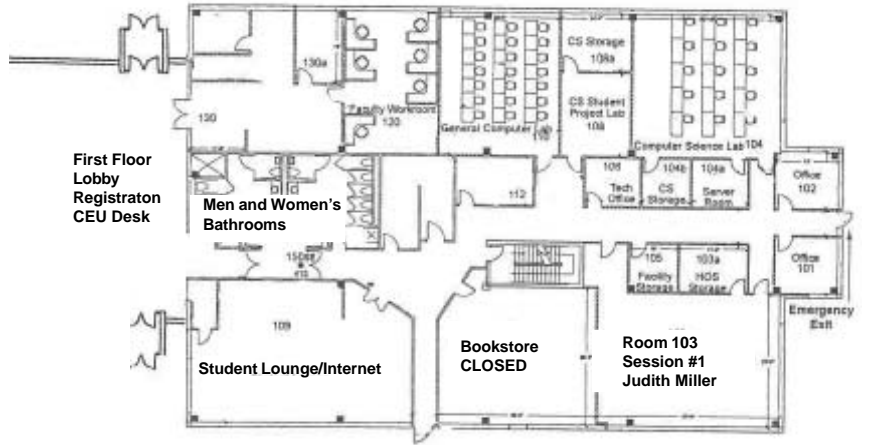
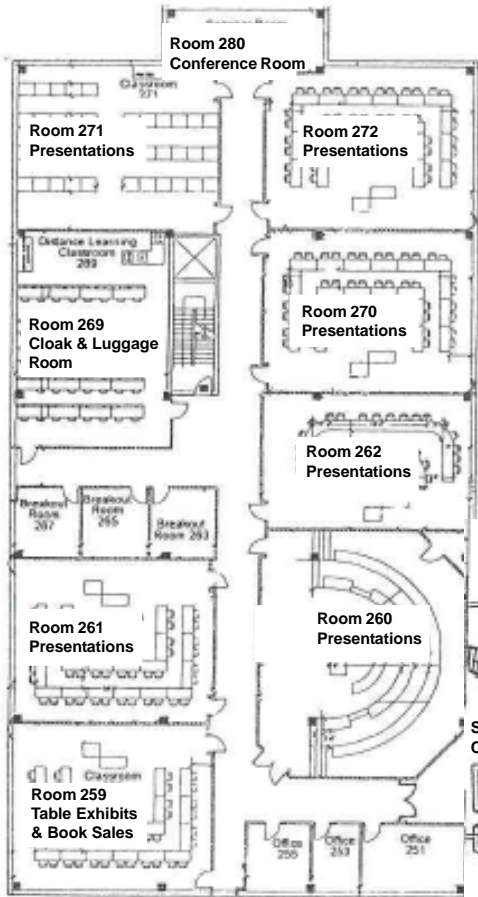

## Second Floor

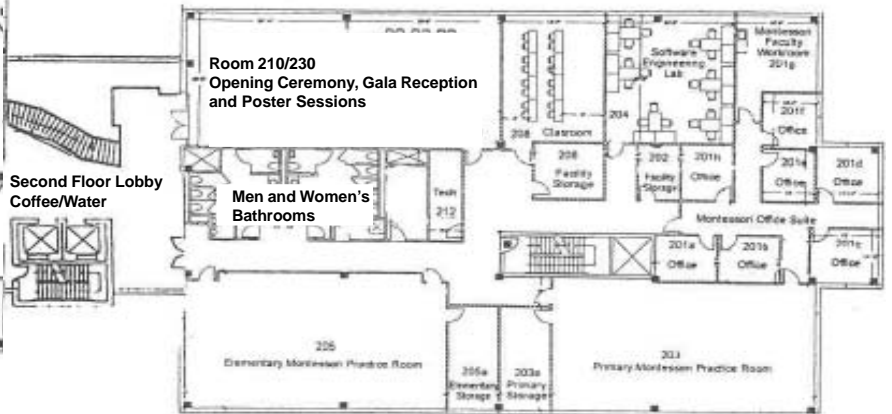

## Third Floor

